

StoneREX Fireproof

For fireplace protection

1. Product description



Interior construction board, fire protection board, construction board

StoneREX Fireproof fire protection board is a safe board for protection of heaters and fireplaces. Smooth-surfaced building board. It consists of cement, cellulose, fillers and binders.

The board is resistant to mold, insects and is very easy to cut and install. The board also has good sound insulation and it is impact resistant. The fire class of the board is A1.

2. Safe distances for fireplace protection

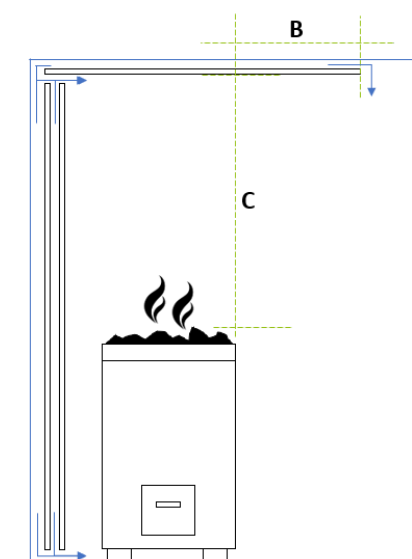

If the recommended safe distances by the heater manufacturer are known:

	Without StoneREX Fireproof boards	Covered with 1x StoneREX Fireproof boards 1x9mm / 1x12 mm	Covered 2x StoneREX Fireproof boards 1x9mm / 1x12 mm
A	Safe distance according to manufacturer's information (mm)	½ safety distance according to the manufacturer's information (mm)	¼ safety distance according to the manufacturer's information (mm)
B	According to the manufacturer's information (mm)	According to the manufacturer's information (mm)	According to the manufacturer's information (mm)
C	Safety distance according to the manufacturer's information (mm)	¾ safety distance according to the manufacturer's information (mm)	-

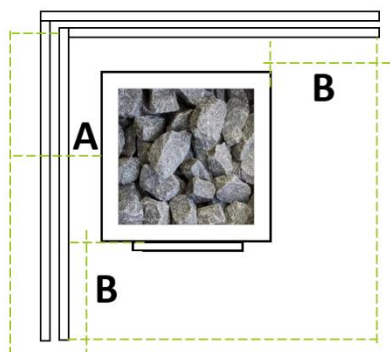

If the recommended safety distances by the heater manufacturer are not known:

Type of the heater	Without protection screen	1x Fireproof disk protection screen	2x Fireproof disk protection screen
Incandescent, uninsulated heater, surface temperature 350-600 °C	A = 1000 mm B = 800 mm C = 1200 mm	A = 500 mm B = 800 mm C = 900 mm	A = 250 mm B = 800 mm
Flammable, isolated heater, surface temperature 140-350 °C	A = 500 mm B = 400 mm C = 1200 mm	A = 250 mm B = 400 mm C = 900 mm	A = 125 mm B = 400 mm



ATTENTION!

The air gap between the board and the base material is at least 30 mm.

When choosing safe distances, in addition to these instructions, always consider local laws and the requirements of the fire department requirements.

StoneREX Fireproof is not suitable as a base board for tiles!

3. Installation

The plate is mounted on the wall using, for example, the decorative screws as seen in the picture →

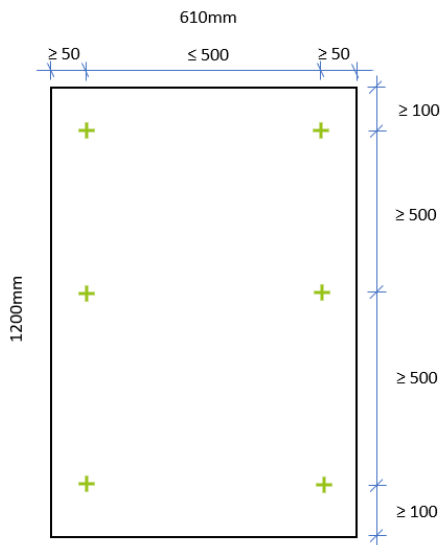

1. Measure and accurately mark the locations of the mounting points to be drilled in the slabs. Observe the minimum edge distances: ≥ 50 mm on the vertical side and ≥ 100 mm on the horizontal side. When installed on the ceiling, the maximum distance between the fasteners is 400 mm.

2. Centering the decorative screws:

To mark the locations of the mounting points on the substructure, first screw the mounting screws into the board at the marked locations without turning the screws through the plate. At least class C3 screws are used to fasten the boards.

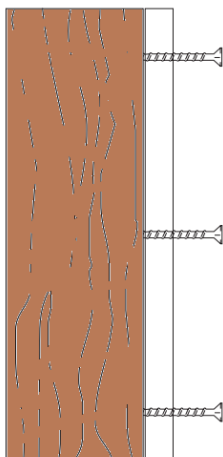
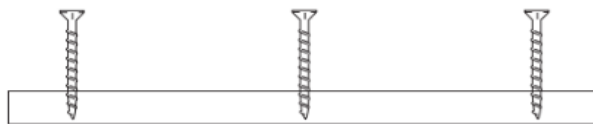

3. Lift the board onto the wall and use a leveler to make sure that the board is straight. Temporarily screw the board to the substructure.

4. Lift the board off the wall and remove the fastening screws.

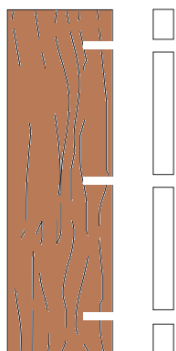

5. Drill holes 3 mm larger than the decorative fixing screw in the marked places (in the holes made with the fixing screws)
6. Drill holes in the substructure in the marked places (in the screw holes made with the fastening screws)

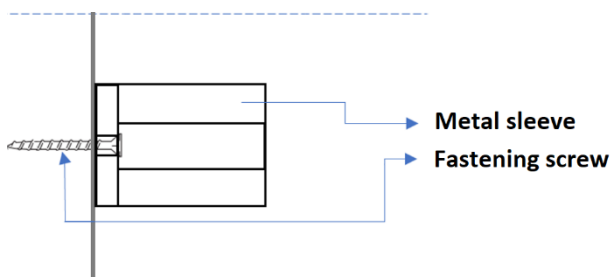

7. Fasten the metal sleeves of the decorative screws with the fastening screws to the wall along the entire thread. (30 mm sleeve ensures a minimum distance from the flammable base material).

8. Lift the board into place and fasten the decorative screw to the metal sleeve by hand.

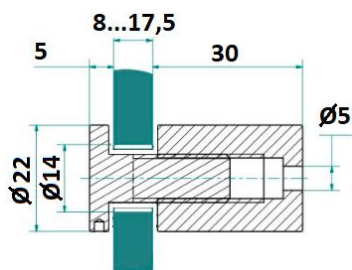
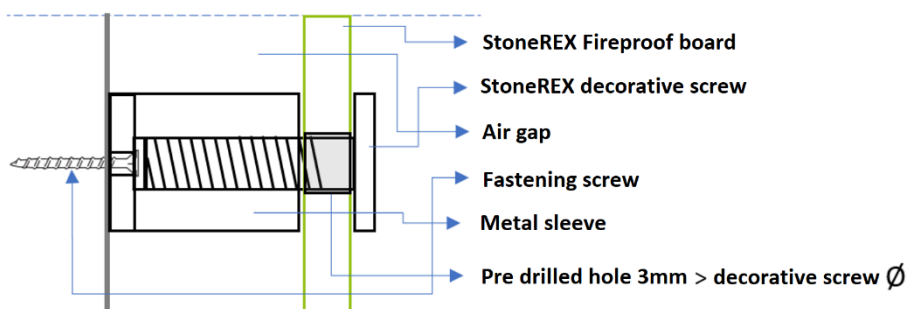

Tools required: Drill, leveler, StoneREX decorative fixing screws with sleeve, marking screws, drills, measuring tape and pencil. Use a hand saw with hardened tooth if you want to cut the boards by hand. For larger amounts use a circular saw diamond blade equipped with a vacuum cleaner. Use personal protective equipment to cut the boards.

4. Processing

- StoneREX Fireproof is cut on the unfinished side (from the back side).
- Cut surfaces are treated with fine-grained sandpaper.
- It is not recommended to cut plates smaller than 300 x 300 mm.
- We recommend using drills with a carbide tip and drilling from the top of the board.
- The hole must be pre-drilled from the diameter of the fixing screw min. 3 mm larger

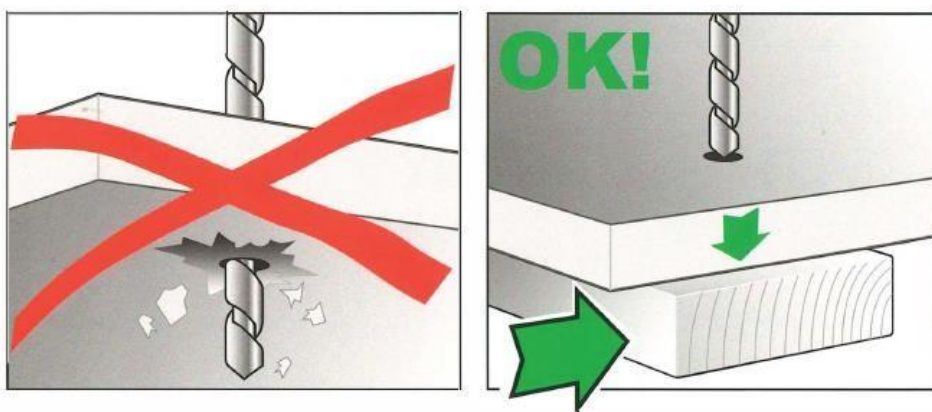

5. Storage and handling of StoneREX Fireproof boards

In StoneREX production, board packs are covered with a transport film to protect the boards from dust. When transporting boards in an open car, care must be taken to ensure that the film installed in the production protects the boards from rain and dirt.

We do not recommend storing the StoneREX Fireproof boards outdoors.

If pallets with the boards are delivered to the construction site and the boards have to be stored outdoors, the protective film must be removed from the packaging and replaced with a tarpaulin, maintaining air circulation around and under the boards. If stored for more than two weeks, the pallets with the boards must be stored in a dry and ventilated room! Do not use a tarpaulin when building the canopy, which does not protect the boards from rain on the sides! Stored boards must be protected on all sides from rain, moisture, snow and dust.



Stored boards must be protected on all sides from rain, moisture, snow and dust.

- When transporting individually, keep the plates upright!
- Do not store the boards on the edge!
- When removing the top board from the package, do not drag the board along the bottom board!
- A maximum of 5 pallets can be stacked on top of each other!

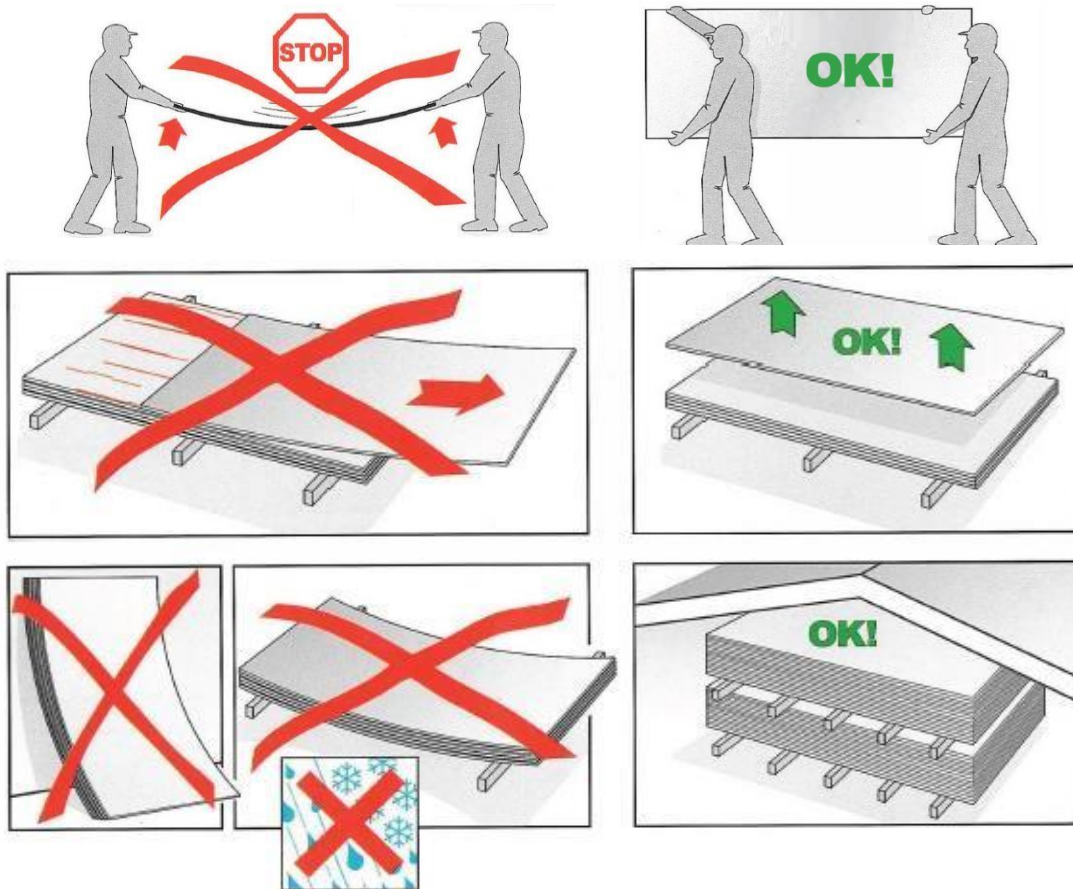

After cutting the boards to size or drilling screw holes into the board, it is necessary to immediately remove the cement dust from the board with a low-pressure compressor, vacuum cleaner, a soft cloth or brush. When wiping visible dust off the board with a wet cloth or glove, the dust will remain on the surface of the board and damage its appearance. Therefore, avoid cutting too close to already mounted boards, so that dust from cutting the new ones do not get on the already mounted boards. Avoid scratching the boards when cutting and processing them.



Wet or damp boards must be dried and if necessary, also cleaned before installation. The surfaces of StoneREX boards should not be washed with water when they are exposed to the sun or hot for any other reason

6. Appearance and color of the board

StoneREX Fireproof boards are not painted, as coloring the boards affects the fire class of the board and is strongly not recommended. We recommend using the same batch of boards when building. The appearance of already installed boards may change slightly over a long period of time due to the surrounding environment.